

asp

Application Service Provider

ADELAIDE HILLS TARMAC SPRINT

WWW.ASPRALLY.COM

rally

South Australian Tarmac Rally Championship & Round 3 SA Rally Championship **Supplementary Regulations** **29th June 2008**



2007 asp Adelaide Hills Tarmac Sprint Winners
Driver Nick Streckeinsen, Co-driver Mike Dale

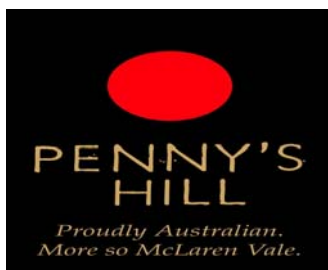

CONTENTS

CONTENTS	2
CLERK OF COURSE'S WELCOME LETTER	3
ARTICLE 1 EVENT SUMMARY	4
ARTICLE 2 EVENT PROGRAM	5
ARTICLE 3 RALLY OFFICE DETAILS	6
ARTICLE 4 ORGANISATION	7
ARTICLE 5 JUDGES OF FACT	8
ARTICLE 6 COMPETITOR ELIGIBILITY	8
ARTICLE 7 VEHICLE ELIGIBILITY	9
ARTICLE 8 DRUGS IN MOTORSPORT	9
ARTICLE 9 RUNNING OF THE RALLY	10
ARTICLE 10 CHANGES CREATED BY CIVIL AUTHORITIES	10
ARTICLE 11 SEEDING	10
ARTICLE 12 ENTRY DETAILS	11
ARTICLE 13 SERVICE AND REFUELING	12
ARTICLE 14 RECONNAISSANCE AND PACE NOTING	12
ARTICLE 15 DOCUMENTATION AND SCRUTINY	13
ARTICLE 16 CHICANES	14
ARTICLE 17 PROTESTS	14
ARTICLE 18 ACCIDENT PROCEDURES	15
ARTICLE 19 RESULTS	15
ARTICLE 20 AWARDS	16
ARTICLE 21 PENALTIES	17
ARTICLE 22 ODOMETER CHECK	18
ARTICLE 23 DRAFT ITINERARY	19
ENTRY FORM	21 - 30

Dear Competitors:

Welcome to the running of the second of the **asp** Adelaide Hills Tarmac Sprint. Once again, we have been given the privilege of running a South Australian Tarmac Rally Championship by the Australian Rally Commission. This year's winner will continue the tradition of becoming the CAMS South Australian Tarmac Rally Champion.

For 2008, this event will also be a round of the South Australian Rally Championship. This is once again a first for Australia with a Tarmac round in a State Rally Championship. Our aim is to provide a Tarmac event that is affordable to the majority of competitors, and act as a stepping-stone to the major national and international tarmac events.

A big thankyou to our major sponsor Application Service Provider (55 Belair Road, Kingswood SA) for their third year in supporting the Southern Districts Car Club. Application Service Provider provides support in many ways from hosting the web page www.asprally.com to designing posters, doing all our major printing and supplying course cars. We also thank Penny's Hill Winery for their continued support and access to their property and amenities.

Thankyou to the South Australian Rally Championship Series Sponsors, Task Australia, Peter Cochrane transport and Rally SA for their continued support of developing rallying in South Australia.

We also need to thank the City of Onkaparinga Council, City of Victor Harbour Council and the Alexandrina Council, and the residents for their valuable support, and allowing us to use the roads within their council areas. As always the event committee strive to minimalise the impact on the residents adjoining the stages we are using. The event committee ask you to please consider the impact you will make on the community while you are out pace noting the event. Any complaints we receive about speeding or inappropriate behaviour on the road up to and during the event will be taken very seriously with the real possibility if proven of competitors being refused to start.

We have continued with the concept of running stages twice to reduce the impact on the traffic movements in the Southern Adelaide Hills and Fleurieu Peninsula. To shorten the road closure times we have separated the route into a northern loop and a southern loop. The 2 stages on the northern loop will be run back to back then we move south to the 3 stages in the southern loop run twice. This year we have 2 new stages near Mt Compass. One is a totally new stage to South Australia and the other is a reversal of a stage.

After the event we welcome you to the presentation dinner at Penny's Hill Winery. This will be held immediately after the completion of competition. Two tickets are included in the entry fee.

Again this year I remind you to be polite and friendly to our many officials that make this event happen. They are all volunteers and the event can't run without them.

Southern Districts Car Club wishes you a safe and enjoyable event.

Thanking You

Michael Clements
Clerk of Course

1 EVENT SUMMARY

Article 1.1 - EVENT SUMMARY

THESE REGULATIONS ARE TO BE READ IN CONJUNCTION WITH THE 2008 CAMS MANUAL, THE 2008 CAMS TARMAC STANDING REGULATIONS, THE 2008 SA RALLY SERIES REGULATIONS, 2008 CONDITIONS OF RALLYING FOR SOUTH AUSTRALIA AND ANY FURTHER REGULATIONS, BULLETINS OR INSTRUCTIONS ISSUED BY THE ORGANISERS.

- 1.1.1 The event will be held under the International Sporting Code of the FIA, the National Competition Rules of CAMS, the National Rally Code, the 2008 Conditions of Rallying for South Australia, the 2008 SA Rally Championship Series Regulations, 2008 Tarmac Standing Regulations with the approval of ARCom, these Event Supplementary Regulations, Further Regulations and any Bulletins or Instructions to competitors that may be issued.
- 1.1.2 Where there is any divergence between THE 2008 CAMS MANUAL, the 2008 CAMS TARMAC STANDING REGULATIONS, THE 2008 SA RALLY SERIES REGULATIONS, THE 2008 CONDITIONS OF RALLYING FOR SOUTH AUSTRALIA and these Event Supplementary Regulations, The Event Supplementary Regulations will take precedence.
- 1.1.3 The Adelaide Hills Tarmac Sprint Rally 2008, hereinafter referred to as 'the event'
- Will be a Special Stage Rally using A to A timing – as per National Rally Code 1.33.
 - Will be a Tarmac Rally using A to A timing – as per National Rally Code 1.33.
 - Is approved to run by CAMS and ARCOM.
 - Will be the stand alone SA Tarmac Rally Championship event, and Round 3 of the SA Rally Championship
 - Is open to Classic – Category 1 to 6 as per CAMS Classic Tarmac Rally Technical Regulations and Modern – M1, M2, M3 and M4 as per CAMS Modern Tarmac Technical Regulations, including PRC and Group N Rally Cars
- 1.1.4 The CAMS Permit Number authorising the event is 508/2906/01
- 1.1.5 The Event will be approximately 330 km, including 10 Special Stages that have a total competitive distance of approximately 57 km including ten bitumen stages. All special stages are of tarmac surface, held in the Southern Adelaide Hills on (closed) public roads.
- 1.1.6 Insurance for the event is covered under CAMS permit No 508/2906/01 Please see Appendix 1 Section 15 Insurance / Fees Part 2 for further details.
- 1.1.7 Crews involved in accidents resulting in property damage are advised that they may be required to pay up to the first \$5000 of any claim to rectify such property damage. Refer Appendix I of the CAMS Manual of Motor Sport for further details regarding insurance cover.

2 EVENT PROGRAM

Article 2.1 - EVENT PROGRAM

Monday	5th May 2008 0900 hrs	Entries open	Rally Office
Monday	9th June 2008 2100 hrs	Standard Entries Close	Rally Office
Monday	16th June 2008 2100 hrs	Final Entries Close	Rally Office
Wednesday & Thursday	25th & 26th June 2008 1820 hrs	Seeded list of entries published	S&J Automotive Accessories
	1830-2030 hrs	Documentation verification (Includes distribution of Road Books, Service Guide, Door Panels and Sponsor Advertising)	S&J Automotive Accessories
	1900-2100 hrs	Turbo Charger Scrutiny & Sealing	S&J Automotive Accessories
	1900-2200 hrs	Scrutineering	S&J Automotive Accessories
Sunday	29th June 2008 0700hrs	Service Park Opens	Penny's Hill Winery
	0700 hrs	Rally Headquarters Opens	Penny's Hill Winery
	0700 hrs	Re-Scrutineering	Penny's Hill Winery
	0815 hrs	Drivers Briefing	Penny's Hill Winery
	0900 hrs	First Car Starts	Penny's Hill Winery
	1615 hrs	First Car Expected to Finish	Penny's Hill Winery
	1700hrs 1800hrs	Post Event Scrutiny	Penny's Hill Winery
	1830 hrs	Provisional Results Announced	Penny's Hill Winery
	1830 hrs	Dinner and Presentation Starts	Penny's Hill Winery
Thursday	10th July 2008 1800 hrs	Final Results posted to SARC registered competitors and posted to website www.sdcc.asn.au	Website

3 RALLY OFFICE DETAILS

Article 3.1 - RALLY OFFICE DETAILS

RALLY & MEDIA ENQUIRIES	<p>Secretary: Debra Shorrock</p> <p>Telephone: 0407 874 050 Email: debra@senet.com.au</p>
CORRESPONDENCE:	<p>Address all correspondence to:</p> <p>The Event Secretary Adelaide Hills Tarmac Sprint Rally 2008 PO Box 54 Seacliff Park SA 5049</p> <p>Telephone: 0407 874 050 Email: debra@senet.com.au</p> <p>No responsibility will be accepted by the organisers for any correspondence lost or sent to any other address</p>
RALLY OFFICE	<p>20 Eyre Street Seaview Downs SA 5049</p> <p>Hours of Operation: 1700 hrs – 2200 hrs Monday 12th May 2008 – 16th June 2008 By appointment only. Please ring and confirm.</p>
RALLY HEADQUARTERS:	<p>Penny's Hill Winery Main Road McLaren Vale SA 5171 (between McLaren Vale and Willunga)</p> <p>Hours of operation : Sunday 29th June 2008 0730 hrs – 1830 hrs</p>
OFFICIAL NOTICE BOARD:	<p>The Notice Board will be in operation at scrutiny during documentation.</p> <p>The Notice Board will be in operation at Rally Headquarters during the 'rally proper'.</p>

4 ORGANISATION

Article 4.1 - ORGANISATION

4.1.1 ORGANISATION AND PROMOTION

- The **Adelaide Hills Tarmac Sprint Rally 2008** will be a State Championship Special Stage (Tarmac) Rally, Held under the International Sporting Code of the FIA and the National Competition Rules of CAMS, the National Rally Code, the Tarmac Rally Standing Regulations, these Event Supplementary Regulations, any further regulations and any authorised Bulletins or instructions to competitors.
- This event will be conducted under and in accordance with CAMS OH&S and Risk Management Policies, which can be found on the CAMS website at www.cams.com.au.
- The organiser and promoter of the Adelaide Hills Tarmac Sprint Rally 2008 to be run on June 29th 2008 is the Southern Districts Car Club.
- The event will be run using A to A Timing as per the National Rally Code.

4.1.2 OFFICIALS OF THE RALLY

CAMS Chief Steward of the Meeting	R Brown
CAMS Stewards of the Meeting	D Charlton C Johnson I Trealor
Course Checker	Jason Lange

4.1.3 ORGANISING COMMITTEE

Clerk of Course	Michael Clements 08 85 373 188 0418 804 105 Fax No. 0885 373135 m.s.clements@bigpond.com
Deputy Clerk of Course	Adrian Smethurst 0417 874 056
Assistant Clerk of Course - Logistics	Darryl Power 0412 808 099
Assistant Clerk of Course - Course	Malcolm Cox 0417 879 044
Chief Safety Officer	Trevor Palmer 0417 840 049
Emergency Services Manager	Denys Clements 0409 284 855
Secretary	Debra Shorrock 0407 874 050 debra@senet.com.au
Officials Coordinator	Carol McGough 0408 286 347 Christine Smallacombe 08 83251296
Results Manager	Mandy Rudham 0417 886 108
Chief Scrutineer	Ashley Dunn 0438 689 683
Competitor Relations Officer	tba tba
Compliance Checker	Marc Tillett 0412 175 224

5 JUDGES OF FACT

Article 5.1 - JUDGES OF FACT

5.1.1 JUDGES OF FACT

In accordance with NCR 181 the following officials are deemed to be Judges of Fact

- Officials of the event are deemed Judges of Fact of the following:
 - Direction of Entry at a Control
 - Dangerous entry in to Control
 - Time of arrival and departure from Control
 - Not wearing seat belt, helmet or safety clothing
 - Wrong direction on a Special Stage
 - Service Park infringements
 - Reconnaissance breaches
 - Hitting or Missing Chicanes
 - Shortcutting the course
- Scrutineers are deemed to be Judges of Fact of the following:
 - Vehicle in un-roadworthy condition
 - Vehicle with accident damage
 - Weight of a vehicle
 - Eligibility of Vehicles
 - Crew Apparel
- Medical Officers are deemed to be Judges of Fact of the Medical condition of
 - Any crew member or team member.
- Speed Monitoring Officials using suitable equipment are deemed to be Judges Fact to the Speed
 - Of a competing vehicle, reconnaissance vehicle or service vehicle.
- SA Police are deemed to be Judges of Fact on open public roads of the following:
 - Traffic infringement
 - Speed of a vehicle
 - Un-roadworthy vehicle

6 COMPETITOR ELIGIBILITY

Article 6.1 - COMPETITOR ELIGIBILITY

- 6.1.1 Both driver and co-driver shall hold, as a minimum, a current CAMS Clubman Rally Licence. Co-drivers who will not drive during the event may hold a National Rally Navigator Only Licence.
Crew members, who hold only a Circuit Racing Licence, shall be required to successfully complete a Rally lecture and then obtain a Rally endorsement for their licence from CAMS, prior to the event.
- 6.1.2 Except Navigators, either crew member may drive the vehicle during the course of The Event.
A crew member who does not hold a Civil Driver's Licence shall not be eligible to drive the vehicle at any stage during The Event
- 6.1.3 The Organisers reserve the right to review and exclude any driver who has been identified in the past or during the event in any officially observed incidents that bring the sport into disrepute, either prior or during the event

7 VEHICLE ELIGIBILITY

Article 7.1 - VEHICLE ELIGIBILITY

7.1.2 Entries will be accepted for the following classes –

SA Tarmac Rally Championship

Class C1 - Classic Category 1 Period B, C and D

Class C2 - Classic Category 2 (1947-1961)

Class C3 - Classic Category 3 (1962-1965)

Class C4 - Classic Category 4 (1966-1971)

Class C5 - Classic Category 5 (1972-1976)

Class C6 - Classic Category 6 (1977-1981)

Class M1 - ages Early Modern, Late Modern and Contemporary

Class M2 - ages Early Modern, Late Modern and Contemporary

Class M3 - ages Early Modern, Late Modern and Contemporary

Class M4/2wd - FIA Group N, CAMS PRC

Class M4/4wd - FIA Group N, CAMS PRC

Early Modern 1982 up to 1990

Late Modern 1990 up to 1997

Contemporary 1998 onwards

Technical Eligibility of vehicles is detailed in the applicable CAMS Tarmac Rally Technical Regulations. Refer to www.camsmanual.com.au.

Round 3 SA Rally Championship

Class PRC1 - up to 1400cc

Class PRC2 - over 1400cc, up to and including 1600cc

Class PRC3 - over 1600cc, up to and including 2000cc

Class PRC4 - 2WD over 2000cc

Class PRC5 - 4WD over 2000cc (not meeting the requirements of Class P6)

Class PRC5S - 4WD over 2000cc (refer to current South Australian Conditions of Rallying)

Class PRC6 - 4WD models first manufactured prior to January 1991 (and appearing on a list of 4WD cars, regardless of the date of manufacture, contained in the current CAMS Manual of Motor Sport)

Class N1 – FIA Group N up to and including 1400 cc

Class N2 - FIA Group N over 1400cc, up to and including 1600cc

Class N3 - FIA Group N over 1600cc, up to and including 2000cc

Class N4 - FIA Group N over 2000cc

Class H1 & 2 - Historic 1 Pre 1968 & Historic 2 1968 – 1975

Class Classic - as per current CAMS Classic Regulations

8 DRUGS IN MOTORSPORT

Article 8.1 - DRUGS IN MOTORSPORT

8.1.1 All Competitors and Service Crew Members are reminded of the CAMS Anti-Doping policy in the Current CAMS Online Manual of Motor Sport (section 2, General Regulations).

8.1.2 Tests for Alcohol may be conducted at any time during the event in accordance with the "Procedure for Alcohol Testing" in the Current CAMS Online Manual of Motor Sport.

9 RUNNING OF THE RALLY

Article 9.1 - RUNNING OF THE RALLY

- 9.1.1 Both driver and co-driver **MUST** be present at Competitors' briefing at 0815 hrs on **29th June 2008** at the Rally Headquarters. Non-attendance will be a penalty of 5 seconds per minute late. - Up to refusal to start.
- 9.1.2 The Rally will start at **0900** hrs on **29th June 2008** and the first car will finish at approx 1615 hrs.
- 9.1.3 Crews deemed to have deliberately placed more than one wheel off the Tarmac in an attempt to short cut, will receive a penalty for each occurrence of 30 seconds per wheel added to their Special Stage time.
- 9.1.4 Cars will start special stages at 1 minute intervals.
- 9.1.5 Crews will be allowed to re-join the rally at a subsequent Time Control during the rally, only with the approval of the Clerk of Course.
- 9.1.6 Special Stages will be closed when the Sweep Car enters the stage. Any crew who arrives at a Special Stage Time Control within their Late Time Limit but after the stage has closed are to drive the stage abiding by all applicable road regulations. A derived time considered by the Stewards to be fairest will be given to the crew. Crews are to enter their own start and finish times on the Time Card if the Control Officials have packed up.
- 9.1.7 Any crew that stops on a Stage and is passed by the Sweep is deemed to have withdrawn from that stage. If they rejoin the stage they are to drive the stage abiding by all applicable road regulations.

10 CHANGES CREATED BY CIVIL AUTHORITIES

Article 10.1 - CHANGES CREATED BY CIVIL AUTHORITIES

- 10.1.1 These regulations are issued subject to any provisions made mandatory for the conduct of the event by the relevant civil authorities between the date of issue of these regulations and the conduct of the event.

11 SEEDING

Article 11.1 - SEEDING

- 11.1.1 Seeding will be in the following order:
- 11.1.2 SA Tarmac Rally Championship competitors will be seeded in the first section at the discretion of the Clerk of Course.
- 11.1.3 SA Rally Championship competitors will be seeded in the second section in accordance with the current DPI those competitors not having a current DPI will be seeded at the discretion of the Clerk of Course.
- 11.1.4 Those entering both the SA Tarmac Rally Championship and the SA Rally Championship will be seeded in the first section according to the current DPI and at the discretion of the Clerk of Course.

12 ENTRY DETAILS

Article 12.1 - ENTRY DETAILS

12.1.1 Completed entries together with the appropriate fee as prescribed in Article 12.1.2 of these regulations should be sent to

The Event Secretary
Adelaide Hills Tarmac Sprint Rally 2008
PO Box 54
Seacliff Park SA 5049

Cheques & Money Orders are to be made payable to the **Southern Districts Car Club Inc.**

12.1.2 The entry fee for the Event is fixed as follows:

➤ **Standard Entries received before 2100 hrs on Monday 9th June 2008**

SA Tarmac Rally Championship	\$625.00
Round 3 SA Rally Championship	
Registered SARC	\$525.00
Standard Entries (non SARC registered)	\$625.00
SA Tarmac Rally Championship & Round 3 SA Rally Championship	
Registered SARC	\$625.00
Standard Entries (non SARC registered)	\$725.00

➤ **Final Entries received after 2100 hrs on Monday 9th June but before 2100 hrs on Monday 16th June 2008**

SA Tarmac Rally Championship	\$725.00
Round 3 SA Rally Championship	
Registered SARC	\$625.00
Standard Entries (non SARC registered)	\$725.00
SA Tarmac Rally Championship & Round 3 SA Rally Championship	
Registered SARC	\$725.00
Standard Entries (non SARC registered)	\$825.00

The entry fee includes –

- CAMS Permit Fee & CAMS Insurance Levy
- One set of Road Books
- One Service crew registration (1 car + 4 crew)
- One set of Service Crew Instructions
- One set of Spectator Instructions
- 2 Presentation Dinner Tickets

Extra Corporate Dinner Tickets are available from \$60.00 per head. Due to catering constraints ALL TICKETS MUST BE ORDERED AND PAID FOR BY THE 16TH JUNE 2008. AS THERE ARE LIMITED TICKETS, IT WILL BE ON A FIRST COME FIRST SERVE BASIS.

- 12.1.3 Additional service crew registrations will be \$20.00 per vehicle (to be registered before the close of Documentation). CAMS Insurance covers registered service crew members only. Only registered service vehicles will be allowed into the service park. All other vehicles must be parked in the spectator parking area (Main Road McLaren Vale) at the front of Penny's Hill Winery. Unauthorised parking will incur a monetary fine.
- 12.1.4 The organisers reserve the right to cancel or postpone the event should the number of entries be less than 40 or due to circumstances which result in force majeure. Maximum limit of entries is 80.
- 12.1.5 Pacenotes will NOT be available from Event Organisers.

13 SERVICE AND RE-FUELING

Article 13.1 - SERVICE AND RE-FUELING

- 13.1.1 The maximum distance between the nominated Service Parks will be approximately 125km (including 17km competitive).
- 13.1.2 Fuel will be available at the following locations: Mt Compass, Willunga and McLaren Vale.
- 13.1.3 Servicing is only permitted within the Service Park at Penny's Hill. At NO OTHER TIME OR PLACE will service be permitted, unless carried out solely by the crew with tools carried within the vehicle and no external assistance.
- 13.1.4 Re-fuelling can ONLY be carried out at any service station by the crew of the car or within the re-fuel zone at the service park by service crews. Time will be allowed within the transport time for refuelling.
- 13.1.5 AVGAS – The use of Avgas is not permitted in South Australia. Any vehicle suspected of using AVGAS will be required to submit to a fuel sample for testing, at the organiser's discretion. Any vehicle suspected to be in breach of the current CAMS fuel requirements will be reported to the Event Stewards. The recommendation penalty will be exclusion.
- 13.1.6 The speed of cars in the service park must not exceed walking pace unless signposted otherwise; offenders will be reported to the Stewards of the Event, who will decide on a penalty.

14 RECONNAISSANCE AND PACE NOTING

Article 14.1 - RECONNAISSANCE AND PACE NOTING

- 14.1.1 Reconnaissance is free and will be available from Saturday 7th June to Sunday 22nd June 2008. Road Books will be issued after the entry form and fees have been received.
- 14.1.2 Crews are reminded that the Road Traffic Act is in effect for all reconnaissance, and that all road rules must be observed (eg. Complying with advisory signs, obeying speed limits imposed and keeping **LEFT**). Judges of Fact may be out on the course in the weeks prior to the event.
- 14.1.3 Reconnaissance may be carried out in any road registered vehicle. It would be advisable not to use a car easily identified as a rally car as we may receive resident complaints that may lead to the loss of a Special Stage. Road traffic noise requirements must be adhered to.
- 14.1.4 Any person found in breach of the reconnaissance regulations, or who acts in such a manner as to bring the rally into disrepute will be reported to the Stewards of the event who will determine a penalty which can include a substantial monetary fine or the refusal to allow the competitor concerned to start the event.

15 DOCUMENTATION AND SCRUTINY

Article 15.1 - DOCUMENTATION AND SCRUTINY

15.1.1 Documentation will be available during the following times (see 15.1.2) and must be completed prior to presentation of that vehicle for scrutiny –

Wednesday 25th and Thursday 26th June, at

S&J Automotive Accessories
33 Woodlands Terrace
Edwardstown S.A. 5039

15.1.2 Vehicles must be presented for scrutiny at the appointed time (you will be contacted with a time once your entry has been received). Those crews wishing to apply for an exemption MUST apply in writing to the Secretary of the Event 2 weeks prior to scrutiny. Failure to comply with these requirements may result in a time penalty or refusal to start the rally being imposed at the discretion of the Stewards of the Meeting.

15.1.3 Vehicles requiring re-scrutiny, or those vehicles granted an exemption from 15.1.2 are required to attend scrutiny at Penny's Hill Winery at 0700 hrs Sunday 29th June 2008

15.1.4 Documents to be presented at documentation include:

- CAMS Competition Licence of BOTH crew members
- CAMS Automobile Log Book
- CAMS Affiliated Club Membership Cards
- Civil Drivers Licence of BOTH crew members (unless Navigator is holder of a "National Rally Navigator Only" Licence)
- Vehicle Registration Papers/Permit

All documents presented must be current & not expire over the duration of the event.

15.1.5 Either the Driver or Co-Driver / Navigator MUST be present at documentation.

15.1.6 SOS/OK Board must be presented with the vehicle at scrutineering.

15.1.7 Vehicles must be presented for turbo scrutiny with cold turbo-chargers. Crews may present the turbo assembly removed from the vehicle.

15.1.8 Any entrant who fails to meet vehicle re-presentation requirements as directed will be refused permission to start the event.

15.1.9 Post event scrutiny will take place within 1 hour of the selected vehicle finishing the event. Those crews concerned will be advised at arrival to the final control.

15.1.10 Of the remaining competitors those who wish may leave the finish after their arrival at the final control by signing a declaration that if subsequently required for scrutiny, they will be deemed to have withdrawn from the rally and will not be eligible for any awards.

15.1.11 Parc fermé will be located at the **Penny's Hill** where all vehicles will be held until post event scrutiny has been completed or the Stewards allow them to be removed.

16 CHICANES

Article 16.1 - CHICANES

- 16.1.1 ArCOM has approved the use of the following Chicanes. Each Chicane will consist of 4 chicane barriers at 12 metre spacing's.
- 16.1.2 Chicanes or Course Markers may be set up in Special Stages. The Chicanes and Course Markers will be constructed from bollards. Any vehicle hitting the upright of the bollard will result in the following penalties:
- 1st Offence: 30 seconds
 - 2nd Offence 1 Minute
 - 3rd Offence 5 Minutes
 - 4th Offence Reported to Stewards for a penalty of up to exclusion.
- 16.1.3 Overtaking is not permitted between 200m chicane warning board and the chicane. The penalty for doing so will be 2 minutes per occurrence.
- 16.1.4 If for any reason a chicane is damaged or a car has stopped within the chicane area and blocked the course, the officials located at the chicane will display a yellow flag. When this flag is displayed each crew MUST slow down after the 200m board to a non-competitive speed. They must exercise extreme caution and be prepared to stop before proceeding carefully through the chicane. Any competitor deemed to be inconvenienced by this or by the chicane official will be given compassionate time off their stage time.

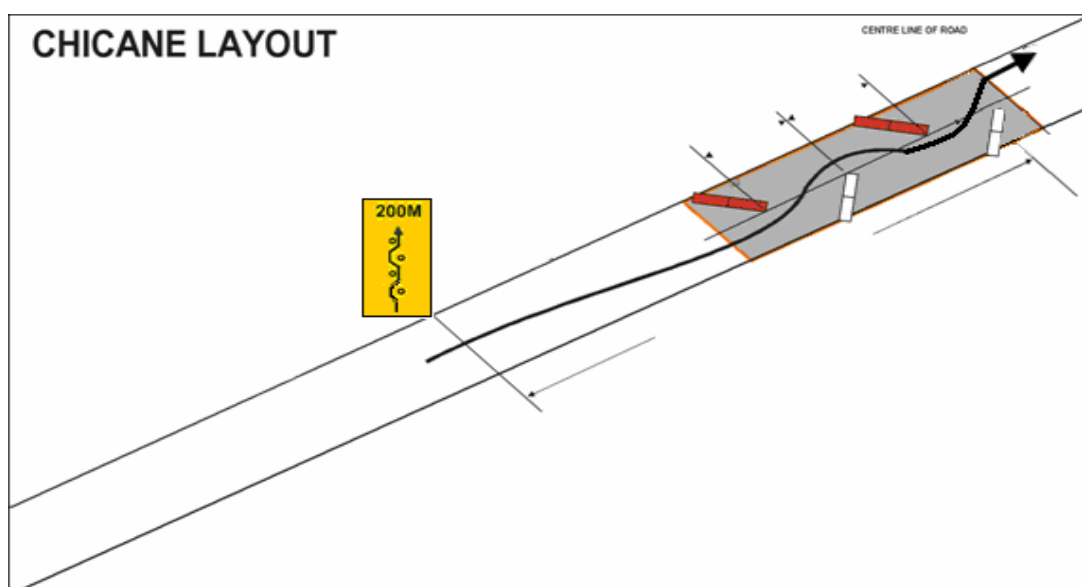

17 PROTESTS

Article 17.1 - PROTESTS

- 17.1.1 Protests, if any, must be lodged in accordance with Part XII of the NCR. Protests relating to the due and proper compilation, assessment or publication of results of the competition shall be lodged within 30 minutes of their being placed on the official notice board.

18 ACCIDENT PROCEDURES

Article 18.1 - ACCIDENT PROCEDURES

- 18.1.1 In the event of a car stopping in a special stage a warning triangle must be immediately be displayed in a conspicuous position at least 50 metres behind the car.
- 18.1.2 In the event of an accident where no injuries are sustained, the OK sign must be clearly displayed to at least the following three cars.
- 18.1.3 Both the warning triangles and the OK sign must be left on display for the whole length of the period that the car is stopped on the course regardless of whether or not the crew remain with the car.
- 18.1.4 Failure to display either the SOS or OK board will result in referral to the stewards with the recommendation of a \$500 fine.
- 18.1.5 Failure to stop at an accident scene with no SOS or OK board showing will result in referral to the stewards with the recommendation of exclusion.
- 18.1.6 If you suffer a break down, you will be able to continue in the rally if you can get your car re-scrutineered at the service park and rejoin at the re-group at Penny's Hill, notify the CRO and slot in before the fast sweep. You will receive a derived time of the slowest time of the stages missed, plus 30seconds for each stage missed. You will be classified after all cars that have completed all stages, in order of stages completed.
- 18.1.7 In the event of an accident where injuries are sustained that require immediate medical attention or where assistance is required with a fire the SOS sign must be displayed to the following cars (unless incapable of doing so), which are required to **STOP**.
- 18.1.8 Any competitor coming on another competitor involved in an accident **MUST STOP** if the SOS is displayed or if there is no visible OK sign displayed, and render assistance. If possible the first vehicle on the scene is to contract Rally Command by mobile phone or radio, noting the car number, cumulative distance to the accident site, and if known, general details of injuries sustained.

The crew on scene are to determine the most appropriate 2 vehicles to immediately transport written accident details to the next SOS point or Stop Point.

No more than 2 vehicles are to proceed past the incident scene without the explicit approval of the Clerk of Course.

The 2 vehicles used to transport details of the incident must proceed to the Stop Point of the stage – after stopping at the first possible communication point if applicable.

At the first practical time crews directly involved must fill in an incident report fully detailing the incident – including actual times of events, and pass it to the Clerk of Course, CRO, or Control official.

19 RESULTS

Article 19.1 - RESULTS

- 19.1.1 Should a special stage be stopped for any reason before the last crew has completed that stage, the result for that Special Stage will be calculated in accordance with NRC 6.9 (ii) Interruption of a special stage
- 19.1.2 Where a crew has stopped during a special stage to render assistance to another crew after an accident where there was a reasonable expectation that bodily harm is imminent or has occurred, then that crew may be awarded a time for that stage based on their previous stage performance's in the event, at the discretion of the Clerk of Course and the Stewards.
- 19.1.3 Final Results will be posted on the [asprally](http://www.asprally.com) web-site on Wednesday 2nd July 2008.

20 AWARDS

Article 20.1 - AWARDS

20.1.1 The Trophy Presentation will be held at Penny's Hill Winery on the 29th June from 1800 hrs to 2100 hrs. All competitors receive 2 tickets with their entry for the presentation dinner. Additional tickets are available at \$60.00 per ticket (if available).

SA TARMAC RALLY CHAMPIONSHIP

Outright

1st Outright Driver and Co-Driver Trophies plus **Free entry into 2009 Adelaide Hills Tarmac Sprint**

Classic Competition

1st Outright Trophies
2nd Outright Trophies
3rd Outright Trophies

Modern Competition

1st Outright Trophies
2nd Outright Trophies
3rd Outright Trophies

Class Awards

C1 Trophies
C2 Trophies
C3 Trophies
C4 Trophies
C5 Trophies
C6 Trophies
M1 Trophies
M2 Trophies
M3 Trophies
M4 2wd Trophies
M4 4wd Trophies

Round 3 SA Rally Championship

1st Outright Trophies
2nd Outright Trophies
3rd Outright Trophies

Class Awards

Class PRC1 - up to 1400cc
Class PRC2 - over 1400cc, up to and including 1600cc
Class PRC3 - over 1600cc, up to and including 2000cc
Class PRC4 - 2WD over 2000cc
Class PRC5 - 4WD over 2000cc (not meeting the requirements of Class P6)
Class PRC5S - 4WD over 2000cc (refer to current South Australian Conditions of Rallying)
Class PRC6 - 4WD models first manufactured prior to January 1991 (and appearing on a list of 4WD cars, regardless of the date of manufacture, contained in the current CAMS Manual of Motor Sport)

Class N1 – FIA Group N up to and including 1400 cc
Class N2 - FIA Group N over 1400cc, up to and including 1600cc
Class N3 - FIA Group N over 1600cc, up to and including 2000cc
Class N4 - FIA Group N over 2000cc
Class H1& 2 - Historic 1 Pre 1968 & Historic 2 1968 – 1975
Class Classic - as per current CAMS Classic Regulations

21 PENALTIES

Offence	Start Refused	Exclusion	Penalty		
			Time	Monetary	Stewards' Decision
ENTRY FEES Entry Fee not paid in full	✿				
SERVICING Servicing or Refuelling in a prohibited area			5 minutes		✿
Speeding in Service Park			5 minutes		✿
Breach of reconnaissance regulations		✿		✿	✿
DOCUMENTATION Failure of driver or co-driver to be present and complete documentation	✿				
Failure to re-present for scrutiny/documentation, if required	✿				
Failure to present to Documentation & Scrutiny at appointed time	Will join end of queue		✿		
Failure to advise of non attendance at documentation & scrutineering			✿		
Hot or not drilled Turbo				✿	✿
START Failure of both driver and co-driver to be present at competitors' briefing	✿			✿	✿
CHICANES			✿ As per Article 16		
SHORTCUTTING THE COURSE			30 seconds per occurrence		
EARLY BOOK INTO CONTROL			1 minute per minute early		
LATE BOOK INTO CONTROL			5 seconds per minute late		

22 ODOMETER CHECK

Article 22.1 - ODOMETER CHECK

22.1.1 CITY

The official odometer check in the 'City' is done by traveling East along Greenhill Rd between two marked power poles and is 5.64km long.

The Start pole is situated 100m West of Goodwood Rd. It has a sign stating "ODO Start" in white letters on a red background.

The end pole is situated east of Burke St (directly opposite Laurel Ave). It is marked "ODO Finish" in white letters on a red background.

22.1.2 SOUTH

The official odometer check in the 'South' is done by traveling South along South Rd between two marked power poles and is 4.16km long.

The Start pole is situated approx 280m south of Sheriffs Rd/Pimpala Rd (directly opposite Stanley Ct). It has a sign stating "ODO Start" in white letters on a red background.

The end pole is situated 270m South of Greengate Gr. It is marked "ODO Finish" in white letters on a red background.

22.1.3 NORTH

The official odometer check in the 'North' is done by traveling North West along McIntyre Rd between two marked poles and is 4.96km long.

The Start pole is situated approx 200m North of Montague Rd (3rd light pole). It has a sign stating "ODO Start" in white letters on a red background.

The end pole is situated 150m East of Booloo St (79 McIntyre Rd). It is marked "ODO Finish" in white letters on a red background.

23 ITINERARY

asp

Application Service Provider

ADELAIDE HILLS TARMAC SPRINT

WWW.ASPRALLY.COM

rally

Road Section	Location	Km	Time Allowed	Avg Speed	Road Closed	1st Competitor	Last Competitor	Road Open
1.0	Penny's Hill Winery Start Old Willunga Hill Rd	3.52	00:05	42.24		09:00 09:05	10:19 10:24	
SS 1	Willunga Hill 1	2.71			08:08	09:08	10:27	11:27
1.1	Old Willunga Hill Rd Wickhams Hill Rd	18.86	00:20	56.58		09:08 09:28	10:27 10:47	
SS 2	Wickhams Hill 1	8.87			08:31	09:31	10:50	11:50
1.2	Wickhams Hill Rd Penny's Hill Service IN	19.12	00:20	57.36		09:31 09:51	10:50 11:10	

Total Competitive 11.58

Total Distance 41.50

1.2	Penny's Hill Service IN Penny's Hill Service OUT	0.00	00:20	0.00		09:51 10:11	11:10 11:30	
1.2	Penny's Hill Regroup IN Penny's Hill Regroup OUT	0.00	00:10	0.00		10:11 10:21	11:30 11:40	
1.2	Penny's Hill Service OUT Old Willunga Hill Rd	3.52	00:05	42.24		10:21 10:26	11:40 11:45	
SS 3	Willunga Hill 2	2.71			09:29	10:29	11:48	12:48
1.3	Old Willunga Hill Rd Wickhams Hill Rd	18.86	00:20	56.58		10:29 10:49	11:48 12:08	
SS 4	Wickhams Hill 2	8.87			09:52	10:52	12:11	13:11
1.4	Wickhams Hill Rd Penny's Hill Service IN	19.12	00:20	57.36		10:52 11:12	12:11 12:31	

Total Competitive 11.58

Total Distance 41.50

Road Section	Location	Km	Time Allowed	Avg Speed	Road Closed	1st Competitor	Last Competitor	Road Open
1.4	Penny's Hill Service IN Penny's Hill Service OUT	0.00	00:30	0.00		11:12 11:42	12:31 13:01	
1.4	Penny's Hill Regroup IN Penny's Hill Regroup OUT	0.00	00:15	0.00		11:42 11:42	13:01 13:01	
1.4	Penny's Hill Regroup OUT Yundi Rd	16.96	00:15	67.84		11:42 11:57	13:01 13:16	
SS 5	Yundi 1	4.51			11:00	12:00	13:19	14:19
1.5	Yundi Rd Tooperang Rd	22.01	00:20	66.03		12:00 12:20	13:19 13:39	
SS 6	Tooperang 1	3.94			11:23	12:23	13:42	14:42

1.6	Tooperang Rd Nettle Hill Rd	21.99	00:20	65.97		12:23 12:43	13:42 14:02	
SS 7	Hindmarsh Tiers 1	8.33			11:46	12:46	14:05	15:05
1.7	Nettle Hill Rd Penny's Hill Service IN	62.62	00:50	75.14		12:46 13:36	14:05 14:55	

Total Competitive 16.78

Total Distance 123.58

1.7	Penny's Hill Service IN Penny's Hill Service OUT	0.00	00:20	0.00		13:36 13:56	14:55 15:15	
1.7	Penny's Hill Regroup IN Penny's Hill Regroup OUT	0.00	00:10	0.00		13:56 14:06	15:15 15:25	
1.7	Penny's Hill Regroup OUT Yundi Rd	16.96	00:15	67.84		14:06 14:21	15:25 15:40	
SS 8	Yundi 2	4.51			13:24	14:24	15:43	16:43
1.8	Yundi Rd Tooperang Rd	22.01	00:20	66.03		14:24 14:44	15:43 16:03	
SS 9	Tooperang 2	3.94			13:47	14:47	16:06	17:06
1.9	Tooperang Rd Nettle Hill Rd	21.99	00:20	65.97		14:47 15:07	16:06 16:26	
SS 10	Hindmarsh Tiers 2	8.33			14:10	15:10	16:29	17:29
1.10	Nettle Hill Rd Penny's Hill Parc Ferme	62.62	01:00	62.62		15:10 16:10	16:29 17:29	

Competitive 16.78

Total Distance 123.58

Total Competitive 56.72

Total Distance 330.16

ENTRY FORM & FEES CHECKLIST - PLEASE RETURN WITH ENTRY FORM

STANDARD ENTRIES RECEIVED BEFORE 2100 HRS ON MONDAY 2ND JUNE 2008		
SA TARMAC RALLY CHAMPIONSHIP		\$625.00
ROUND 3 SA RALLY CHAMPIONSHIP		
REGISTERED SARC		\$525.00
STANDARD ENTRIES (NON SARC REGISTERED)		\$625.00
SA TARMAC RALLY CHAMPIONSHIP & ROUND 3 SA RALLY CHAMPIONSHIP		
REGISTERED SARC		\$625.00
STANDARD ENTRIES (NON SARC REGISTERED)		\$725.00
FINAL ENTRIES RECEIVED AFTER 2100 HRS ON MONDAY 2ND JUNE 2008 BUT BEFORE 2100 HRS ON MONDAY 16TH JUNE 2008		
SA TARMAC RALLY CHAMPIONSHIP		\$725.00
ROUND 3 SA RALLY CHAMPIONSHIP		
REGISTERED SARC		\$625.00
STANDARD ENTRIES (NON SARC REGISTERED)		\$725.00
SA TARMAC RALLY CHAMPIONSHIP & ROUND 3 SA RALLY CHAMPIONSHIP		
REGISTERED SARC		\$725.00
STANDARD ENTRIES (NON SARC REGISTERED)		\$825.00
EXTRA SERVICE CREW	@ \$20.00	
EXTRA DINNER TICKETS	@ \$60.00	
EVENT CAPS	@ \$20.00	
EXTRA ROAD BOOK	@ \$20.00	
TOTAL		\$
COMPLETED ENTRY FORM		YES / NO
COMPLETED CREW DISCLAIMERS		YES / NO
COMPLETED SERVICE CREW REGISTRATION AND DISCLAIMERS		YES / NO
RECEIPT REQUIRED		YES / NO

"Held under the International Sporting Code of the FIA and the National Competition Rules of CAMS."

ENTRANT

Name:

Address:

Mobile

CAMS Licence Number:

Expiry Date:

DRIVER:

Name:

Date of Birth:

Address:

Telephone: (mobile)

(hm)

(wk)

Email:

Civil Licence Number:

Club:

Club Member No:

CAMS Licence: Number:

Type: IR NR NRJ NRNO CR CRN

Expiry Date:

Emergency contact Person:

Mobile:

Emergency contact Person:

Mobile:

DRIVERS PREVIOUS EVENTS & RESULTS (FOR SEEDING)

1.

2.

3.

4.

"Held under the International Sporting Code of the FIA and the National Competition Rules of CAMS."

CO – DRIVER / NAVIGATOR			
Name:		Date of Birth:	
Address:			
Telephone: (mobile)	(hm)	(wk)	
Email:			
Civil Licence Number:	Club:	Club Member No:	
CAMS Licence: Number:	Type: IR NR NRJ NRNO CR CRN	Expiry Date:	
Emergency contact Person:	Mobile		
Emergency contact Person:	Mobile		
VEHICLE DESCRIPTION			
Make	Model	Body Type	Year
Colour	Rego Number	Reg. Expires	2WD / 4WD
Class	Logbook No	Capacity	
PACENOTING / RECONNAISSANCE VEHICLE DETAILS			
Make	Model	Year	
Colour	Rego Number	Reg. Expires	

DISCLAIMER DRIVER & CO-DRIVER/NAVIGATOR EXCLUSION OF LIABILITY, RELEASE AND ASSUMPTION OF RISK COMPETITORS AND/OR COMPETING CREWS AND/OR SERVICE CREW IN RALLIES

For Competitors

I/We being the competitor/s of the vehicle described on this Entry Form wish to enter that vehicle for the above event.

For Competitors and competing crew/ and service crew

I/We being the competitor/s and/or driver and/or co-driver and/or navigator and/or service crew, certify that the particulars on this form are true and correct in every particular, to the best of my/our knowledge and belief.

I/We declare that I/we have read and understood the Supplementary Regulations issued for the event, and agree to be bound by them and the provisions of the National Competition Rules of the Confederation of Australian Motor Sport Limited ("CAMS").

In exchange for being able to attend or participate in the event (including entering the event), I agree:

- to release CAMS and Australian Motor Sport Commission Ltd, promoters, sponsor organisations, land owners and lessees, organisers of the event, their respective servants, officials, representatives and agents (collectively, the "**Associated Entities**") from all liability for my death, personal injury (including burns), psychological trauma, loss or damage (including property damage) ("**harm**") howsoever arising from my participation in or attendance at the event, except to the extent prohibited by law;
- that CAMS and the Associated Entities do not make any warranty, implied or express, that the event services will be provided with due care and skill or that any materials provided in connection with the services will be fit for the purpose for which they are supplied; and
- to attend or participate in the event at my own risk.
I/we acknowledge that:
- the risks associated with attending or participating in the event include the risk that I may suffer harm as a result of:
 - motor vehicles (or parts of them) colliding with other motor vehicles, persons or property;
 - acts of violence and other harmful acts (whether intentional or inadvertent) committed by persons attending or participating in the event; and
 - the failure or unsuitability of facilities (including grand-stands, fences and guard rails) to ensure the safety of persons or property at the event.
- motor sport is dangerous and that accidents causing harm can and do happen and may happen to me.
- the route instructions should not be relied upon exclusively in estimating the degree of severity of any hazard which might be encountered, or the manner in which any section of the road is driven, whether shown in the route instructions or not, and that I/We have been advised to exercise caution in following these route instructions.

I accept the conditions of, and acknowledge the risks arising from, attending or participating in the event and being provided with the event services by CAMS and the Associated Entities.

I/we acknowledge that my/our personal information will be processed in accordance with the CAMS privacy policy which is available from the www.cams.com.au and where I/we suffer from any injury, sickness or death during the Event, I/we consent to the release by health services of my/our personal health information to an authorised representative of CAMS or the Event who may use it in the preparation and release within and outside Australia of accident or incident information and reports to interested parties for the purposes of accident investigation, accident prevention and safety activities, news services including broadcast services, or for the purposes of processing insurance claims.

I understand that this disclaimer is not intended to exclude any valid claim I may have under the CAMS Personal Insurance Scheme.

Competitor's signature: Date:

Driver/s signature: Date:

Navigator/Co-Driver/s signature: Date:

DISCLAIMER EXCLUSION OF LIABILITY, RELEASE AND ASSUMPTION OF RISK COMPETITORS AND/OR COMPETING CREWS AND/OR SERVICE CREW IN RALLIES

For Competitors

I/We being the competitor/s of the vehicle described on this Entry Form wish to enter that vehicle for the above event.

For Competitors and competing crew/ and service crew

I/We being the competitor/s and/or driver and/or co-driver and/or navigator and/or service crew, certify that the particulars on this form are true and correct in every particular, to the best of my/our knowledge and belief. I/We declare that I/we have read and understood the Supplementary Regulations issued for the event, and agree to be bound by them and the provisions of the National Competition Rules of the Confederation of Australian Motor Sport Limited ("**CAMS**").

In exchange for being able to attend or participate in the event (including entering the event), I agree:

- to release CAMS and Australian Motor Sport Commission Ltd, promoters, sponsor organisations, land owners and lessees, organisers of the event, their respective servants, officials, representatives and agents (collectively, the "**Associated Entities**") from all liability for my death, personal injury (including burns), psychological trauma, loss or damage (including property damage) ("**harm**") howsoever arising from my participation in or attendance at the event, except to the extent prohibited by law;
- that CAMS and the Associated Entities do not make any warranty, implied or express, that the event services will be provided with due care and skill or that any materials provided in connection with the services will be fit for the purpose for which they are supplied; and
- to attend or participate in the event at my own risk.
I/we acknowledge that:
 - the risks associated with attending or participating in the event include the risk that I may suffer harm as a result of:
 - motor vehicles (or parts of them) colliding with other motor vehicles, persons or property;
 - acts of violence and other harmful acts (whether intentional or inadvertent) committed by persons attending or participating in the event; and
 - the failure or unsuitability of facilities (including grand-stands, fences and guard rails) to ensure the safety of persons or property at the event.
 - motor sport is dangerous and that accidents causing harm can and do happen and may happen to me.
 - the route instructions should not be relied upon exclusively in estimating the degree of severity of any hazard which might be encountered, or the manner in which any section of the road is driven, whether shown in the route instructions or not, and that I/We have been advised to exercise caution in following these route instructions.
- I accept the conditions of, and acknowledge the risks arising from, attending or participating in the event and being provided with the event services by CAMS and the Associated Entities.

I/we acknowledge that my/our personal information will be processed in accordance with the CAMS privacy policy which is available from the www.cams.com.au and where I/we suffer from any injury, sickness or death during the Event, I/we consent to the release by health services of my/our personal health information to an authorised representative of CAMS or the Event who may use it in the preparation and release within and outside Australia of accident or incident information and reports to interested parties for the purposes of accident investigation, accident prevention and safety activities, news services including broadcast services, or for the purposes of processing insurance claims.

I understand that this disclaimer is not intended to exclude any valid claim I may have under the CAMS Personal Insurance Scheme.

For persons under the age of 18 years the following parent/guardian consent must be completed.

PARENT/ GUARDIAN CONSENT – PERSONS UNDER 18 YEARS OLD

I of [Address] am the parent/ guardian* of the above-named ("the minor") who is under 18 years old. I have read this document and understand its contents, including the exclusion of liability and assumption of risk, and have explained the contents to the minor. I consent to the minor attending/ participating in* the event at his/her own risk.

Signed.....

Date.....

Parent/Guardian*

- Delete whichever does not apply

SERVICE CREW REGISTRATION – VEHICLE 1			
Make	Model	Year	
Colour	Registration Number	Reg. Expires	
Name	Mobile	Signature	Date
Name	Mobile	Signature	Date
Name	Mobile	Signature	Date
Name	Mobile	Signature	Date

Version – October 2007

DISCLAIMER - EXCLUSION OF LIABILITY, RELEASE AND ASSUMPTION OF RISK - RALLY SERVICE CREW DISCLAIMER

I/We being a member of/the service crew certify that the particulars on this form are true and correct in every particular, to the best of my/our knowledge and belief.

In exchange for being able to attend or participate in the event, I/we agree:

- To release Confederation of Australian Motor Sport Ltd ("**CAMS**") and Australian Motor Sport Commission Ltd, promoters, sponsor organisations, land owners and lessees, organisers of the event, their respective servants, officials, representatives and agents (collectively, the "**Associated Entities**") from all liability for my death, personal injury (including burns), psychological trauma, loss or damage (including property damage) ("**harm**") howsoever arising from my participation in or attendance at the event, except to the extent prohibited by law:
- That CAMS and the Associated Entities do not make any warranty, implied or express, that the event services will be provided with due care and skill or that any materials provided in connection with the services will be fit for the purpose for which they are supplied: and
- To attend or participate in the event at my own risk.
- That Service crew members must be over the age of 15 years. Where a person under 18 years is part of a service crew they require parental/ guardian consent and that crew member/s must be under adult supervision at all times.

I/We acknowledge that:

- The risks associated with attending or participating in the event include the risk that I may suffer harm as a result of:
 - Motor vehicles (or parts of them) colliding with other motor vehicles, persons or property:
 - Acts of violence and other harmful acts (whether intentional or inadvertent) committed by persons attending or participating in the event; and
 - The failure or unsuitability of facilities (including grand-stands, fences and guard rails) to ensure the safety of persons or property at the event.
- Motor sport is dangerous and that accidents causing harm can and do happen and may happen to me.
- The route/service crew instructions should not be relied upon exclusively in estimating the degree of severity of any hazard which might be encountered, or the manner in which any section of the road is driven, whether shown in the route instructions or not, and that I/we have been advised to exercise caution in following these route/service crew instructions.

I accept the conditions of, and acknowledge the risks arising from, attending or participating in the event and being provided with the event services by CAMS and the Associated Entities.

I/we acknowledge that my/our personal information will be processed in accordance with the CAMS privacy policy which is available from the www.cams.com.au and where I/we suffer from any injury, sickness or death during the Event, I/we consent to the release by health services of my/our personal health information to an authorised representative of CAMS or the Event who may use it in the preparation and release within and outside Australia of accident or incident information and reports to interested parties for the purposes of accident investigation, accident prevention and safety activities, news services including broadcast services, or for the purposes of processing insurance claims.

I understand that this disclaimer is not intended to exclude any valid claim I may have under the CAMS Personal Insurance Scheme.

SERVICE CREW REGISTRATION – VEHICLE 2			
Make	Model	Year	
Colour	Registration Number	Reg. Expires	
Name	Mobile	Signature	Date
Name	Mobile	Signature	Date
Name	Mobile	Signature	Date
Name	Mobile	Signature	Date

Version – October 2007

DISCLAIMER - EXCLUSION OF LIABILITY, RELEASE AND ASSUMPTION OF RISK - RALLY SERVICE CREW DISCLAIMER

I/We being a member of/the service crew certify that the particulars on this form are true and correct in every particular, to the best of my/our knowledge and belief.

In exchange for being able to attend or participate in the event, I/we agree:

- To release Confederation of Australian Motor Sport Ltd ("**CAMS**") and Australian Motor Sport Commission Ltd, promoters, sponsor organisations, land owners and lessees, organisers of the event, their respective servants, officials, representatives and agents (collectively, the "**Associated Entities**") from all liability for my death, personal injury (including burns), psychological trauma, loss or damage (including property damage) ("**harm**") howsoever arising from my participation in or attendance at the event, except to the extent prohibited by law:
- That CAMS and the Associated Entities do not make any warranty, implied or express, that the event services will be provided with due care and skill or that any materials provided in connection with the services will be fit for the purpose for which they are supplied: and
- To attend or participate in the event at my own risk.
- That Service crew members must be over the age of 15 years. Where a person under 18 years is part of a service crew they require parental/ guardian consent and that crew member/s must be under adult supervision at all times.

I/We acknowledge that:

- The risks associated with attending of participating in the event include the risk that I may suffer harm as a result of:
 - Motor vehicles (or parts of them) colliding with other motor vehicles, persons or property:
 - Acts of violence and other harmful acts (whether intentional or inadvertent) committed by persons attending or participating in the event; and
 - The failure or unsuitability of facilities (including grand-stands, fences and guard rails) to ensure the safety of persons or property at the event.
- Motor sport is dangerous and that accidents causing harm can and do happen and may happen to me.
- The route/service crew instructions should not be relied upon exclusively in estimating the degree of severity of any hazard which might be encountered, or the manner in which any section of the road is driven, whether shown in the route instructions or not, and that I/we have been advised to exercise caution in following these route/service crew instructions.

I accept the conditions of, and acknowledge the risks arising from, attending or participating in the event and being provided with the event services by CAMS and the Associated Entities.

I/we acknowledge that my/our personal information will be processed in accordance with the CAMS privacy policy which is available from the www.cams.com.au and where I/we suffer from any injury, sickness or death during the Event, I/we consent to the release by health services of my/our personal health information to an authorised representative of CAMS or the Event who may use it in the preparation and release within and outside Australia of accident or incident information and reports to interested parties for the purposes of accident investigation, accident prevention and safety activities, news services including broadcast services, or for the purposes of processing insurance claims.

I understand that this disclaimer is not intended to exclude any valid claim I may have under the CAMS Personal Insurance Scheme.

DISCLAIMER - EXCLUSION OF LIABILITY, RELEASE AND ASSUMPTION OF RISK - RALLY SERVICE CREW DISCLAIMER

I/We being a member of/the service crew certify that the particulars on this form are true and correct in every particular, to the best of my/our knowledge and belief.

In exchange for being able to attend or participate in the event, I/we agree:

- To release Confederation of Australian Motor Sport Ltd ("**CAMS**") and Australian Motor Sport Commission Ltd, promoters, sponsor organisations, land owners and lessees, organisers of the event, their respective servants, officials, representatives and agents (collectively, the "**Associated Entities**") from all liability for my death, personal injury (including burns), psychological trauma, loss or damage (including property damage) ("**harm**") howsoever arising from my participation in or attendance at the event, except to the extent prohibited by law:
- That CAMS and the Associated Entities do not make any warranty, implied or express, that the event services will be provided with due care and skill or that any materials provided in connection with the services will be fit for the purpose for which they are supplied: and
- To attend or participate in the event at my own risk.
- That Service crew members must be over the age of 15 years. Where a person under 18 years is part of a service crew they require parental/ guardian consent and that crew member/s must be under adult supervision at all times.

I/We acknowledge that:

- The risks associated with attending of participating in the event include the risk that I may suffer harm as a result of:
 - Motor vehicles (or parts of them) colliding with other motor vehicles, persons or property:
 - Acts of violence and other harmful acts (whether intentional or inadvertent) committed by persons attending or participating in the event; and
 - The failure or unsuitability of facilities (including grand-stands, fences and guard rails) to ensure the safety of persons or property at the event.
- Motor sport is dangerous and that accidents causing harm can and do happen and may happen to me.
- The route/service crew instructions should not be relied upon exclusively in estimating the degree of severity of any hazard which might be encountered, or the manner in which any section of the road is driven, whether shown in the route instructions or not, and that I/we have been advised to exercise caution in following these route/service crew instructions.

I accept the conditions of, and acknowledge the risks arising from, attending or participating in the event and being provided with the event services by CAMS and the Associated Entities.

I/we acknowledge that my/our personal information will be processed in accordance with the CAMS privacy policy which is available from the www.cams.com.au and where I/we suffer from any injury, sickness or death during the Event, I/we consent to the release by health services of my/our personal health information to an authorised representative of CAMS or the Event who may use it in the preparation and release within and outside Australia of accident or incident information and reports to interested parties for the purposes of accident investigation, accident prevention and safety activities, news services including broadcast services, or for the purposes of processing insurance claims.

I understand that this disclaimer is not intended to exclude any valid claim I may have under the CAMS Personal Insurance Scheme.

For persons under the age of 18 years the following parent/guardian consent must be completed. Note: 16 years is the minimum age for a member of the service crew.

PARENT/ GUARDIAN CONSENT – PERSONS UNDER 18 YEARS OLD

I of [Address]am the parent/ guardian* of the above-named ("the minor") who is under 18 years old. I have read this document and understand its contents, including the exclusion of liability and assumption of risk, and have explained the contents to the minor. I consent to the minor attending/ participating in* the event at his/her own risk.

Signed.....
Parent/Guardian*

Date.....

* Delete whichever does not apply



Declaration of co-driver without civil licence National Rally Code, Article 2.1 (iii)

To be completed at Pre-Event Documentation

I _____

CAMS Licence Number _____

Of _____

In the state of: _____ declare and agree that in accordance with the CAMS' National Rally Code, Article 2.1(iii), I will not drive the car for which I am entered in the Event, being the: Adelaide Hills Tarmac Sprint Rally 2008, as I have not presented my civil licence at this time of pre-event documentation.

Signature: _____ **Date:** _____

Print Full Name _____

MEDIA INFORMATION

DRIVER		CO-DRIVER	
Name		Name	
Nick Name		Nick Name	
Age		Age	
Occupation		Occupation	
Home Town	State	Home Town	State
Car Club(s)		Car Club(s)	
Best Two Rally Results			
Most Spectacular Retirement			
VEHICLE			
Make	Year	Model	
Class	Drive RWD / FWD / 4WD	Colour	
Capacity	cc		
Modifications			
History of Car			
Sponsors			